

All ideas, designs, arrangements and plans indicated or represented by this drawing are owned by and the property of SCHWEIZER · WALDROFF ARCHITECTS, incorporated, and were created, evolved and developed for the use on and in connection with this specific project.

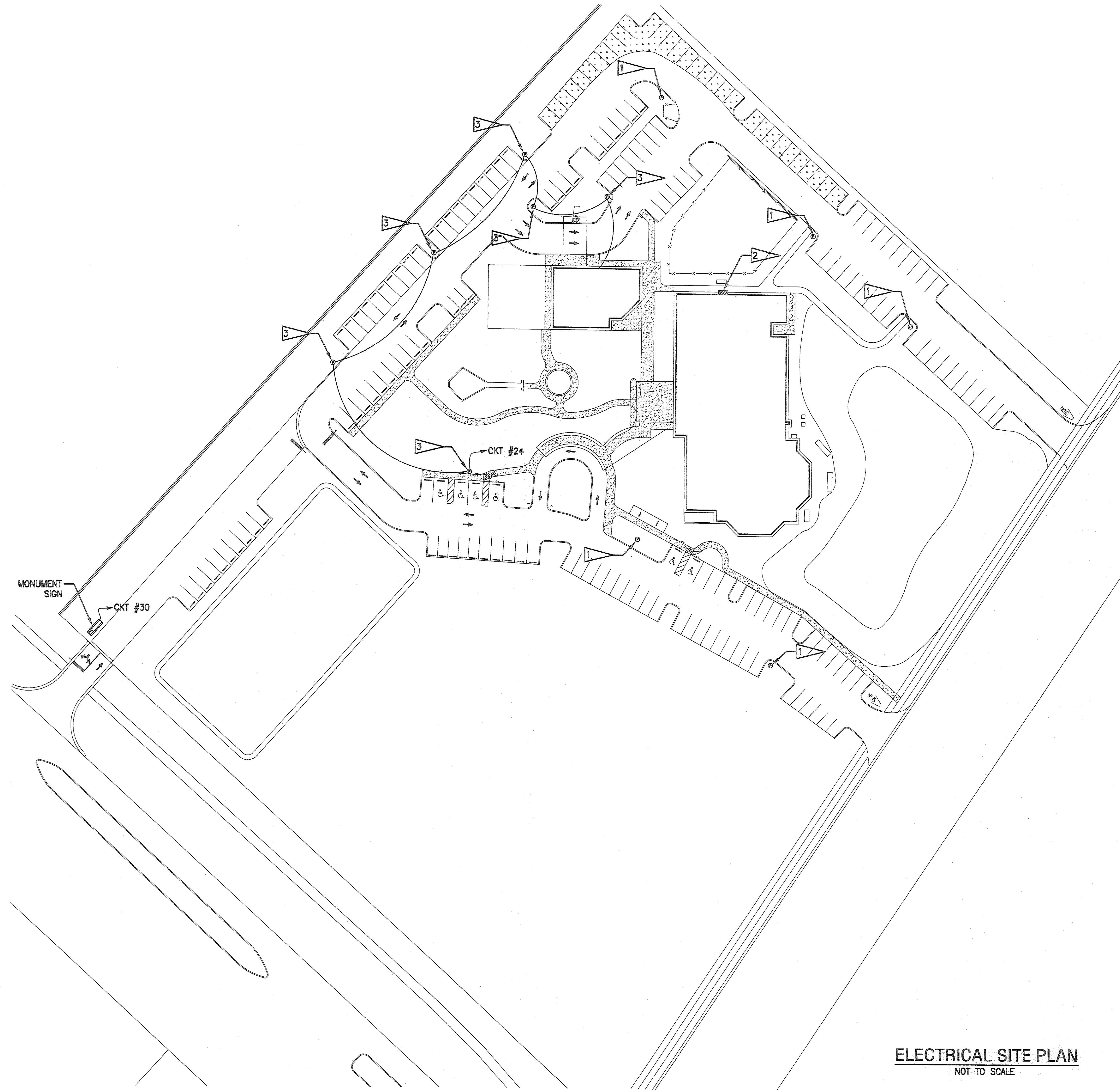

ELECTRICAL SITE PLAN
NOT TO SCALE

GENERAL NOTES

1. ALL WORK SHALL BE IN ACCORDANCE WITH THE 2008 NATIONAL ELECTRIC CODE (NEC), NFPA 70.
2. ALL NEW SITE LIGHTING SHALL BE CONNECTED USING 10AWG THWN WIRE IN 1/2" SCH 40 PVC CONDUIT BURIED 24" BELOW GRADE.
3. ALL OUTDOOR EQUIPMENT INSTALLED SHALL BE NEMA 3R.
4. PARKING LIGHTS AND MONUMENT SIGN SHALL BE CONNECTED TO SEPARATE 365 DAY TIMERS WITH PHOTO CELL INPUT FOR CONTROL. TIMERS TO BE LOCATED IN MECHANICAL ROOM.
5. LIGHT POLES SHALL BE INSTALLED IN ACCORDANCE WITH MANUFACTURER'S INSTRUCTIONS.

FLAG NOTES

1. CUT EXISTING LIGHT POLE TO 14' AND INSTALL NEW 2-28W LED SIGHT LIGHTING FIXTURES.
2. EXISTING 1200A, 208/120VAC 3P, 4W MAIN DISTRIBUTION PANEL. FEED NEW BUILDING FROM NEW CIRCUIT.
3. INSTALL NEW 14' FIBERGLASS POLE WITH 2-28W LED SIGHT LIGHTING FIXTURES.

LEGEND

- Ⓟ FIBERGLASS LIGHT POLE
- ▨ EXISTING MAIN DISTRIBUTION PANEL
- ▭ MONUMENT SIGN

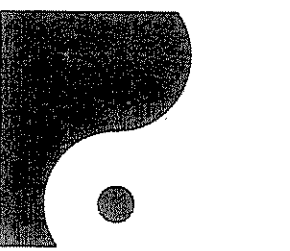

**SCHWEIZER
WALDROFF**
ARCHITECTS
Incorporated

ARCHITECTURE
145 CANAL STREET · NEW SMYRNA BEACH, FLORIDA 32189 · (386) 426-0466 · FAX (386) 426-0718
ARCHITECTURE LICENSE NO. AA-0003143

LANDSCAPE
INTERIOR DESIGN
WEBSITE: www.swaarb.com

PORT ORANGE PRESBYTERIAN CHURCH
PORT ORANGE, FLORIDA

1/11/2012

ELECTRICAL
SITE PLAN
SHEET NUMBER

E1

Nelson Engineering Co.
5335 North Courtenay Pkwy
Merritt Island, FL 32953
(321) 448-1128 Fax (321) 448-1195
www.NelsonEngrCo.com